

# DOORS

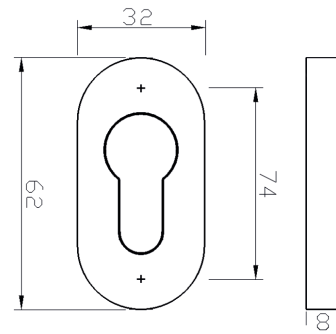

## ELITE ESCUTCHEON

The stylish Elite Stainless Steel Escutcheon suites perfectly with other products in the Trojan Stainless Steel range. The Elite Escutcheon is manufactured in 316 Stainless Steel, giving ultimate corrosion resistance and comes with a 25 year guarantee.



### TECHNICAL SPECIFICATION

#### Product Material Specifications:

- 316 Stainless Steel

#### Testing:

- Corrosion tested in excess of 1000 hours based on BS EN1670

#### Box Quantity:

- 20

The Elite Stainless Steel range includes T Bar Handle, Central Door Knob, Escutcheon, Door Handle, Door Knocker, Numerals and Letters.

#### Part Code

10E001



### SPECIAL FEATURES SUMMARY:

- Manufactured in 316 Stainless Steel
- Suites with other Trojan Stainless Steel furniture for a totally coordinated, modern door suite
- Produced from 1.2mm thickness material
- The Elite Escutcheon consists of an SS201 inner complete with screw fixings (standard screws supplied) and a 316 Stainless Steel cover for a concealed fix application

\* Guarantee subject to correct installation and maintenance

#### Trojan Manufacturing Group Limited

Fryers Road, Bloxwich, Walsall, West Midlands, WS2 7LZ

T: +44 (0)1922 713933 F: +44 (0)1922 713890

E: [info@trojanguroup.com](mailto:info@trojanguroup.com) W: [www.trojanguroup.com](http://www.trojanguroup.com)

Trojan Group operate a continuous development and improvement programme and therefore reserve the right to amend designs and specifications.

## ASSA ABLOY

An ASSA ABLOY Group brand Registration No: 2096505  
School Street, Willenhall, West Midlands, WV13 3PW

ELITE ESCUTCHEON